

# User Manual

## IMPORTANT SAFETY INSTRUCTIONS

This electrical appliance must always be used according to the following safety instructions. Save these instructions as this manual contains important safety and operating information. When using an electrical appliance, basic precaution should always be followed, including the following:

### **READ ALL INSTRUCTIONS CAREFULLY BEFORE USING THIS APPLIANCE:**

#### **To reduce the risk of fire, electric shock or injury:**

1. Always press the Vacuum Power button on the bottom of the unit to the off position, and the trash bin Power button on the top of the unit to the off position before unplugging the EyeVac+.
2. Always unplug the appliance before cleaning or servicing it. Do not unplug by pulling the cord; to unplug, grasp the plug, not the cord.
3. Do not let the EyeVac+ be used as a toy. Close attention is necessary when used near children. Do not use in Auto mode or leave appliance plugged in near children, infants or small animals.
4. Do not pull or carry the appliance by the cord. Do not run the appliance over the cord, close a door on the cord, or pull the cord around sharp edges or corners. Keep the cord away from heated surfaces.
5. Do not use the appliance if the cord or plug is damaged.
6. Do not handle the plug or appliance with wet hands.
7. Do not use appliance on wet surfaces.
8. Do not expose to rain.
9. Do not use appliance to dispose of water or damp materials such as mud, tile grout, plaster filler, or caulking. Do not use to pick up any liquid or wet objects.
10. Do not use appliance to vacuum up flammable or combustible liquids, such as gasoline. Do not use in areas where these liquids may be present.
11. Do not use this appliance to vacuum up burning or smoking materials, such as cigarettes, matches or hot ashes.
12. Keep hair, loose clothing, and all parts of the body, especially fingers, away from openings and moving parts.
13. Do not put any objects into appliance openings or use with any openings blocked or plugged.
14. Do not use this appliance to pick up hard or sharp objects or other large surface litter. Pick these up by hand before vacuuming.
15. Do not operate without the Lid and Filters properly in place.
16. Use the appliance only as described in this Use and Care Guide.
17. Turn appliance off (both Power buttons) before removing or replacing the Canister or Filter.
18. Unplug appliance before cleaning or maintenance.
19. If the appliance is not working as it should, call for instructions where to send for repair. Do not attempt to repair, as it will invalidate your warranty.
20. When cleaning the outside of the appliance, wipe with a damp cloth to reduce the static electricity on the outer surface.

**WARNING! To reduce the risk of electric shock, do not use on wet surfaces. Do not expose to rain. Store indoors.**

## DESCRIPTION OF EYEVAC+ Save These Instructions For Household Use Only



**1. Canister Lid**

**2. Pre-Motor Filter**

**3. Vacuum Canister**

**4. Serial Number  
(located on back of unit)**

**5. Sensor- trash bin**

**6. Inlet**

**7. Sensor - Vacuum**

**8. Vacuum Manual Activation Button**

**9. Vacuum Power button**

**10. Vacuum Auto mode**

**11. Vacuum Manual mode**

**12. Vacuum Canister full indicator**

**13. Exhaust Filter Housing**

**14. Exhaust Filter  
(not shown, located on back of unit)**

**15. Trash bin lid**

**16. Trash bin lid Power button**

## BEFORE USING FOR THE FIRST TIME

1. Remove EyeVac+ from packaging and set upright on any non-carpeted flooring.
2. Plug unit into any standard 120V(US) AC electrical outlet.

**NOTE: EYEVAC+ CANNOT BE USED WITH A CONVERTER OR ADAPTER**

3. Press the Vacuum Power button to the MAN position for Manual operation or to the Auto position for automated use. The Power indicator light will illuminate when the Power button is in either of these positions. Switch the trash bin Lid Power button to the On position. Your EyeVac+ is now ready for use.

## GROUNDING INSTRUCTIONS

This appliance must be grounded. If it should malfunction or breakdown, grounding provides a path of least resistance for electric current to reduce the risk of electric shock. This appliance is equipped with a cord having an equipment-grounding conductor and grounding plug. The plug must be inserted into an appropriate outlet that is properly installed and grounded.

## Replace Trash Bags

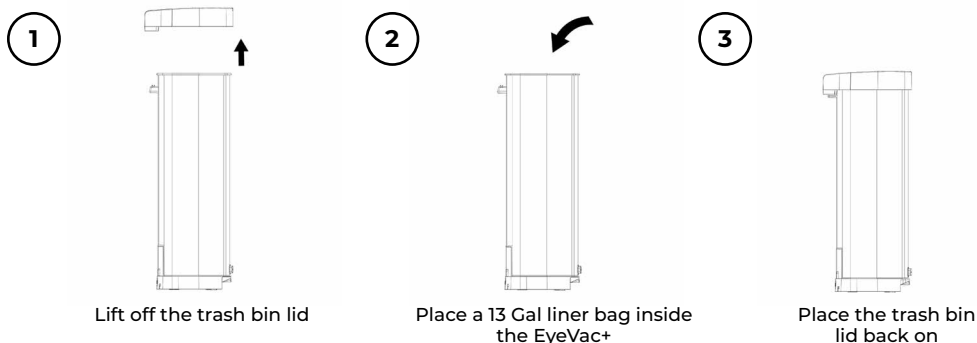

## Opening the Lid Top

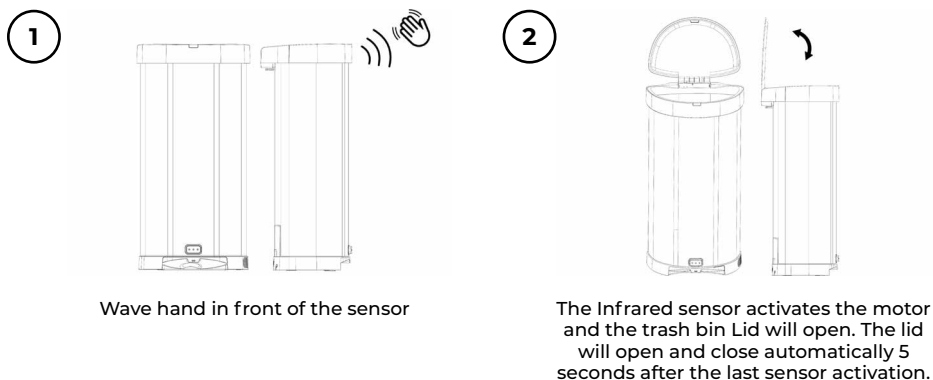

**Tip:** To keep the trash bin lid open, wave your hand in front of the trash bin lid Sensor for 3 seconds. The trash bin lid will open and remain open. To close Lid and return to normal operation, wave your hand in front of the trash bin lid Sensor for 3 seconds.

1



Open the Canister and ensure the Pre-Motor Filter is aligned properly and in place. Then, re-insert the Canister. EyeVac+ will not operate if the canister is not inserted properly.

2



Plug in your EyeVac+ in the desired location.

3



Press Power button to indicate either Manual or Auto modes

Press the Vacuum Power button (located on the bottom of the unit) to turn ON. EyeVac+ will be in Auto mode. Press the Vacuum Power button again to select Manual mode

4



When ready, simply sweep debris towards the Inlet. If in Auto mode the Vacuum Sensors will detect the sweeping motion. If in Manual mode simply tap the Manual Activation button and the Vacuum will activate.

5



Canister full

As debris accumulates, the Canister will need to be emptied. The Canister full indicator illuminates Red to let you know when its time to empty the Canister.

## USER MAINTENANCE INSTRUCTIONS

1. To empty the EyeVac+ Canister, press the Vacuum Power button to the off position, press the trash bin lid Power button to the off position, and unplug the unit.
2. Pull the Canister outward from the bottom of the Bin Cavity. Grasp the Canister Grip firmly and lift it out and away from the EyeVac+ Main Unit.
3. Holding the Canister firmly with one hand, grasp the Canister Lid Handle with the other hand and pull the Lid straight up and out to remove.
4. Turn the Canister upside down over a trash can. Make sure you empty all dirt and debris from inside and below the Bin. To ensure that all the dirt spills out, tap the side of the Canister gently against the edge of the trash can. Re-attach the Canister Lid to the top of the Canister.
5. Clean Sensors, Dirt Inlet area, Canister, Canister Lid and Canister Cavity with a damp rag or towel. Do not use soap or alcohol to clean sensors.
6. After all parts are fully dried, insert the assembled Canister with Lid fitted snugly into position and Pre-Motor Filter locked into place. The 2 grooves in the bottom of the Bin fit easily over the rod in the front of the unit. Grasp the Canister grip and lock the Canister back into position.

**NOTE: Make sure all parts are completely dry before reassembly.**

**HEALTH TIP: If you suffer from allergies or asthma, take the Canister outdoors to empty. As you empty the dirt into the trash can, gently tap the Canister against the side of the can to remove loose debris.**

## CLEANING THE PRE-MOTOR FILTER

To maintain optimal performance, the Pre-Motor Filter will need cleaning whenever the suction is not strong. The Pre-Motor Filter must be clean and free of elements, which might hinder the flow of air.

1. To empty the EyeVac+ Canister, press the Vacuum Power button to the off position, press the trash bin lid Power button to the off position, and unplug the unit.
2. Pull the Canister outward from the front of the Bin Cavity. Grasp the Canister grip firmly and lift it out and away from the EyeVac+ Main Unit. Locate the Pre-Motor Filter Handle.
3. Remove the Pre-Motor Filter by grasping the Filter Handle and turn counter-clockwise to the unlock position. Pull Filter straight up and out of the top of the Canister. Rinse under running water to clean. If needed a mild soap and soft bristled brush can also be used.

**IMPORTANT! Dry thoroughly before use.**

4. Slide the Pre-Motor Filter back into the top of the Canister. Rotate clockwise to the "lock" position. Put the Canister back into place.
5. If a new Filter is needed, replace with standard filter cartridges. Make sure that it fits snugly in the Filter Holder. Replacement Filters are available through the Customer Service Department.

**IMPORTANT! NEVER OPERATE THE EYEVAC+ WITHOUT THE PRE-MOTOR FILTER PROPERLY IN PLACE.**

## CLEANING THE EXHAUST FILTER HOLDER

1. To clean the Exhaust Filter Holder, press the Vacuum Power button to the off position, press the trash bin lid Power button to the off position, and unplug the unit.
2. The Exhaust Filter Holder slides up and out of its housing on the side of the unit.
3. Gently pull the Filter out of the Filter Holder.
4. Tap Filter gently against trash container to free and eliminate excess dirt and debris.
5. To clean the Filter, wash in mild soap and water; rinse and dry thoroughly before assembly
6. Slide the Holder back into the unit with the Filter facing outwards.

**IMPORTANT! NEVER OPERATE EYEVAC+ WITHOUT THE EXHAUST FILTER & FILTER HOLDER PROPERLY IN PLACE.**

## CLEANING THE CANISTER

The Canister should be washed periodically.

1. To clean the EyeVac+ Canister, press the Vacuum Power button to the off position, press the trash bin lid Power button to the off position, and unplug the unit.
2. Wash the Bin in warm water using a mild soap. Avoid harsh or abrasive cleaners or sponges. Rinse thoroughly.

**TO AVOID DAMAGE, DO NOT PLACE CANISTER IN THE DISHWASHER.**

3. Let it air dry. Make sure the Canister is completely dry before putting it back into the EyeVac+.
4. Insert the assembled Canister following the instructions outlined in the USER MAINTENANCE INSTRUCTIONS.

**IMPORTANT! Other than cleaning the Pre-Motor Filter and replacing the Exhaust Filter Holder, as described in this Owner Manual, this EyeVac+ is not user serviceable. There are no user serviceable parts inside the unit. Servicing by our Authorized Service Center is required to avoid damage to internal components.**

## STORAGE

1. To store the EyeVac+ press the Vacuum Power button to the off position, press the trash bin lid Power button to the off position, and unplug the unit.
2. Store EyeVac+ indoors, in a clean, dry place.
3. Never store EyeVac+ while it is still plugged in. Never wrap cord tightly around the appliance, use the Cord Storage area on the back of the EyeVac+ unit. Do not put any stress on the cord where it enters the unit, as it could cause the cord to break.

**WARNING! TO REDUCE THE RISK OF ELECTRIC SHOCK, DO NOT USE OUTDOORS OR ON WET SURFACES.**

## TROUBLESHOOTING

Problem	Possible Cause	Possible Solution
EyeVac+ will not turn on/ no power	<ol style="list-style-type: none"> <li>1. Not firmly plugged in</li> <li>2. EyeVac+ is in off position</li> <li>3. Pre-Motor Filter is not in correct position</li> <li>4. No power in wall plug</li> <li>5. Blown house fuse or tripped circuit breaker</li> </ol>	<ol style="list-style-type: none"> <li>1. Plug in firmly</li> <li>2. Press Power button to Manual or Auto position</li> <li>3. Ensure that Pre-Motor Filter is locked and flush with Canister in place</li> <li>4. Check house fuse or circuit breaker</li> <li>5. Have a qualified licensed electrician replace house use or reset circuit breaker.</li> <li>6. Remove Canister to check switch inside cavity above Pre-Motor Filter is positioned</li> </ol>

### Vacuum:

Does not pick up debris	<ol style="list-style-type: none"> <li>1. Dirt inlet is blocked</li> <li>2. Canister is full</li> <li>3. Debris may be too large for Inlet</li> </ol>	<ol style="list-style-type: none"> <li>1. Press Power button to turn off EyeVac Air</li> <li>2. Clean path of dirt Inlet</li> <li>3. Empty Canister</li> <li>4. Clear large debris</li> </ol>
Sensor does not activate	<ol style="list-style-type: none"> <li>1. EyeVac+ is not in Auto mode</li> </ol>	<ol style="list-style-type: none"> <li>1. Press Power button to the Auto position</li> </ol>
Suction not strong	<ol style="list-style-type: none"> <li>1. Pre-Motor Filter may be dirty</li> </ol>	<ol style="list-style-type: none"> <li>1. Press Power button to turn off</li> <li>2. Clean filters when needed</li> </ol>
Status indicator light blinking	<ol style="list-style-type: none"> <li>1. EyeVac+ sensors have been shut off for 30 seconds which caused power to the motor to be shut off</li> </ol>	<ol style="list-style-type: none"> <li>1. Press Power button to the power off</li> <li>2. Check Pre-Motor Filter, and Exhaust Filter to ensure they are clean.</li> <li>3. Clean sensors with warm water and Q-tip. DO NOT USE ALCOHOL OR SOAP.</li> </ol>
Canister full indicator light is on	<ol style="list-style-type: none"> <li>1. Canister is full</li> </ol>	<ol style="list-style-type: none"> <li>1. Press Power button to turn off</li> <li>2. Empty the Canister</li> <li>3. Clean all filters</li> </ol>
Debris at Inlet before unit is powered on	<ol style="list-style-type: none"> <li>1. EyeVac+ is not in Auto mode</li> </ol>	<ol style="list-style-type: none"> <li>1. Press Power button to the Manual position</li> <li>2. Activate EyeVac+ manually</li> </ol>

If your problem is not listed, please contact Customer Support.

## TROUBLESHOOTING-CONTINUED

Trash Bin		
No power to the lid	<ol style="list-style-type: none"> <li>1. EyeVac+ is not plugged in</li> <li>2. Trash bin sensor is off</li> <li>3. Liner bag is not bag not properly secured</li> <li>4. The Motor Interruptor Feature is activated</li> <li>5. EyeVac+ is not on appropriately placed</li> </ol>	<ol style="list-style-type: none"> <li>1. Plug in firmly</li> <li>2. Ensure the lid Power switch is in the on position.</li> <li>3. Ensure the liner bag is not covering the Power connector, located on the back of the lid</li> <li>4. Ensure there is no objects or pressure on the lid</li> <li>5. Power on and off using the on/off Power switch located on the back of the lid <b>Do not push or force the lid up or down</b></li> <li>6. Do not place EyeVac+ too close to a wall</li> </ol>
Lid not opening or closing all the way	<ol style="list-style-type: none"> <li>1. EyeVac+ is not plugged in</li> <li>2. Trash bin sensor is off</li> <li>3. Liner bag is not bag not properly secured</li> <li>4. The Motor Interruptor feature is activated</li> <li>5. EyeVac+ is not appropriately placed</li> </ol>	<ol style="list-style-type: none"> <li>1. Plug in firmly</li> <li>2. Ensure the lid Power switch is in the on position.</li> <li>3. Ensure the liner bag is not covering the Power connector, located on the back of the lid</li> <li>4. Ensure there is no objects or pressure on the lid</li> <li>5. Turn the Power on and off using the on/off Power switch located on the back of the lid <b>Do not push or force the lid up or down</b></li> <li>6. Do not place EyeVac+ too close to a wall</li> </ol>

If your problem is not listed, please contact Customer Support.

## CORRECT DISPOSAL OF THIS PRODUCT



This marking indicates that this product should not be disposed with other household wastes. To prevent possible harm to the environment or human health from uncontrolled waste disposal, recycle it responsibly to promote the sustainable reuse of material resources. To return your used device, please use the return and collection systems or contact the retailer where the product was purchased. They can take this product for environmentally safe recycling. This appliance is a dry pick-up, Canister type vacuum cleaner for household and indoor use. It is also a general-purpose vacuum cleaner, which can be used for hard floor cleaning.

## LIMITED WARRANTY

One-Year Limited Warranty. What is covered: JPauJones, LPTM warrants to the first retail purchaser of this EyeVac+ that should this product or any part be proved defective in materials or workmanship from the date of proof of purchase for a period of one (1) year, then it will be subject to the terms of this one-year limited warranty. Such defects will be replaced, or credit issued at JPauJones, LP's option, without charge for parts or labor directly related to the defect. Limitations and Exclusions: This warranty gives you specific legal rights and you may also have other rights which vary from state to state. This warranty does not apply to any cost incurred for removal or re-installation, or to any product or part thereof which has suffered through normal wear and tear, alteration, improper installation, physical abuse, misuse, neglect or accident. Nor does it cover defects caused by shipment to JPauJones, LP or repair or service of the product by anyone other than JPauJones, LP. Damage resulting from an unforeseen circumstance including but not limited to fire, flood, earthquake, and other natural causes will be excluded. This Limited warranty is in lieu of all other warranties, express or implied either in fact or by operations of law, statutory or otherwise, including, but not limited to any implied warranty of merchantability or fitness for a particular use. JPauJones, LP does not authorize any other person to assume any liability beyond the warranty herein described. In no event, whether based in contract or tort shall be liable for incidental, inconsequential, indirect, special or punitive damages of any kind from the use of this product. In no event shall be liable for damage in excess of the purchase price. EyeVac+ not for commercial use.

For Warranty Service, submit a Service Request at <http://eyevac.com/connect/> or contact: JPauJones, LP, 7500 Rialto Blvd., Bldg. 1, Suite 122, Austin, TX 78735 or call 512-485-3050.

©2014 JPauJones, LP Intellectual Property. All rights reserved, JPauJones, LP, JPauJones, LP logo and all other marks contained herein are trademarks of JPauJones, LP Intellectual Property and/ or JPauJones, LP affiliated companies.

# JPauJones™

JPauJones, LP™  
7500 Rialto Blvd, Bldg. 1 STE. 122  
Austin, TX 78735  
(512) 485-3050

For service and general inquiries please visit [www.eyevac.com/connect](http://www.eyevac.com/connect)



eye  vac<sup>®</sup>